

SECTION F-F AND H-H
SECTION G-G AND K-K
SCALE — 1" = 8'

SHEET NO. 2
PLAN NO. 1013
IN THE MATTER OF
ACQUISITION AND IMPROVEMENT DISTRICT NO. 3
OF THE CITY OF SAN BERNARDINO, CALIF.
ASSESSMENT DISTRICT MAP NO. 1013
AND
PLANS AND PROFILES NO. 1013
FOR THE IMPROVEMENT OF
STATE STREET
BETWEEN
CAJON STATE HIGHWAY AND BASE LINE STREET
IN THE
COUNTY OF SAN BERNARDINO, CALIF.

NOVEMBER, 1929
 PLAN ADOPTED
 DECEMBER, 1, 1930.
 NOTE: See Sheet No. 1 for legend.
R. DORR SYTHE
 ENGINEER OF WORK



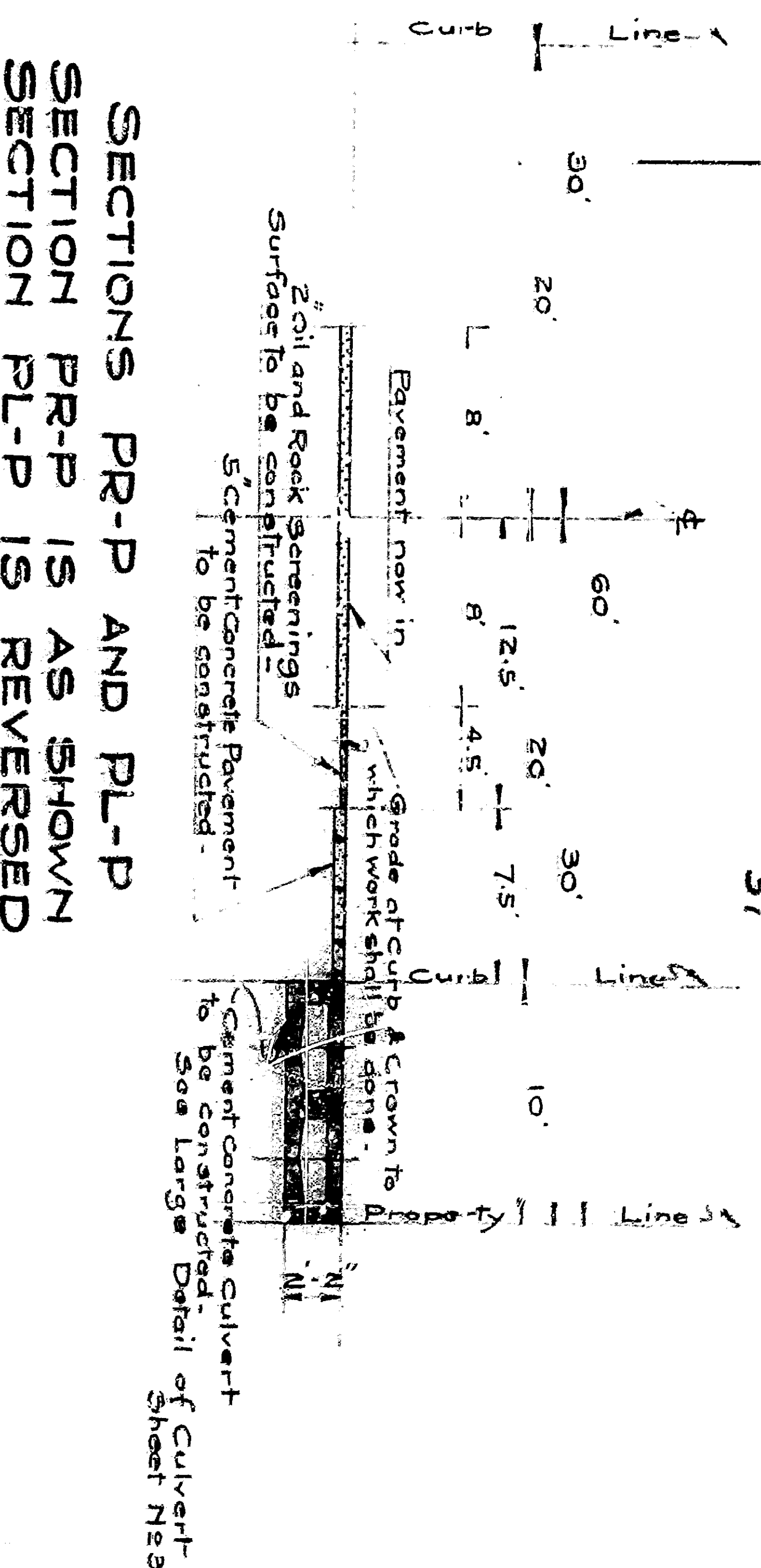

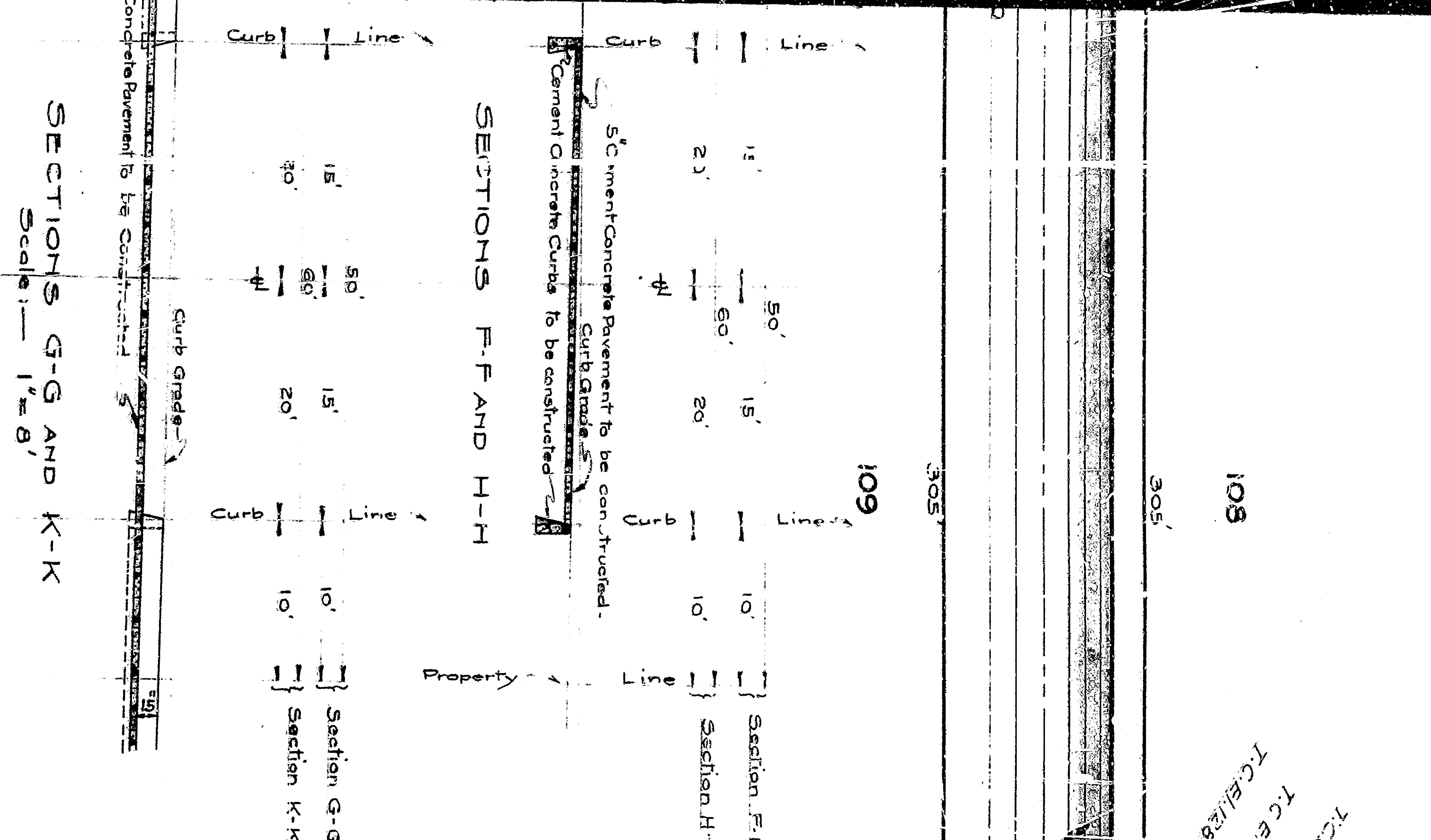

SHEET No. 2
 PLAN No. 1013

**IN THE MATTER OF
 ACQUISITION AND IMPROVEMENT DISTRICT No. 3
 OF THE CITY OF SAN BERNARDINO, CALIF.
 PLANS AND PROFILES No. 1013
 AND
 ASSESSMENT DISTRICT MAP No. 1013
 FOR THE IMPROVEMENT OF
 STATE STREET
 BETWEEN
 CAJON STATE HIGHWAY AND BASE LINE STREET
 IN THE
 COUNTY OF SAN BERNARDINO, CALIF.**

NOVEMBER, 1929
 PLAN ADOPTED DECEMBER 1, 1930.
 R. D. ROBYNTH
 ENGINEER OF WORK

NOTE: See Sheet No. 1 for legend.

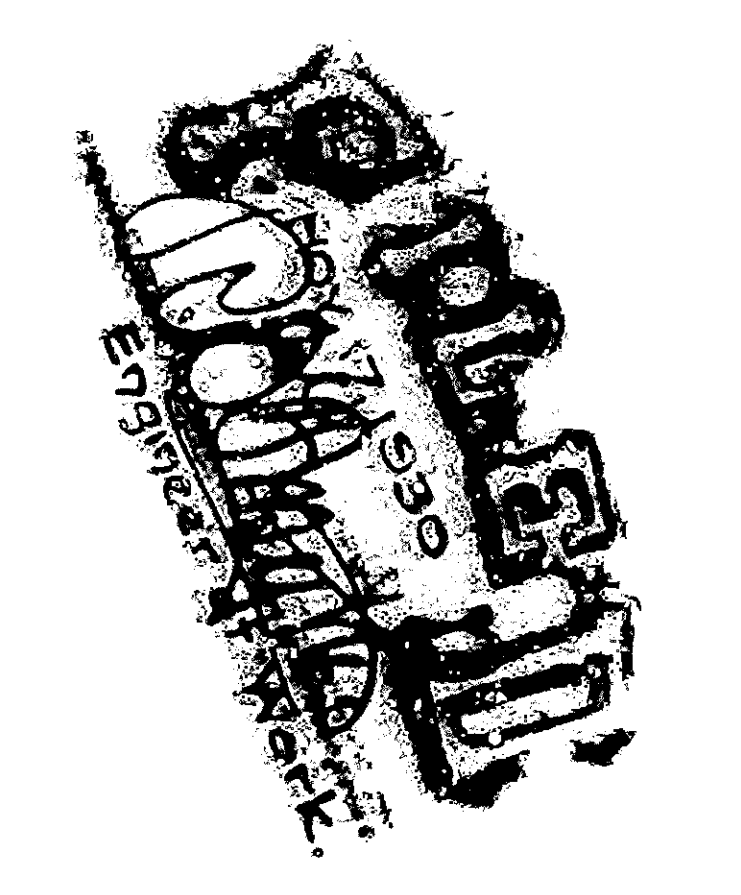

**SECTIONS P-R-P AND P-L-P
 SECTION P-R-P IS AS SHOWN
 SECTION P-L-P IS REVERSED**
 Scale — 1" = 8'


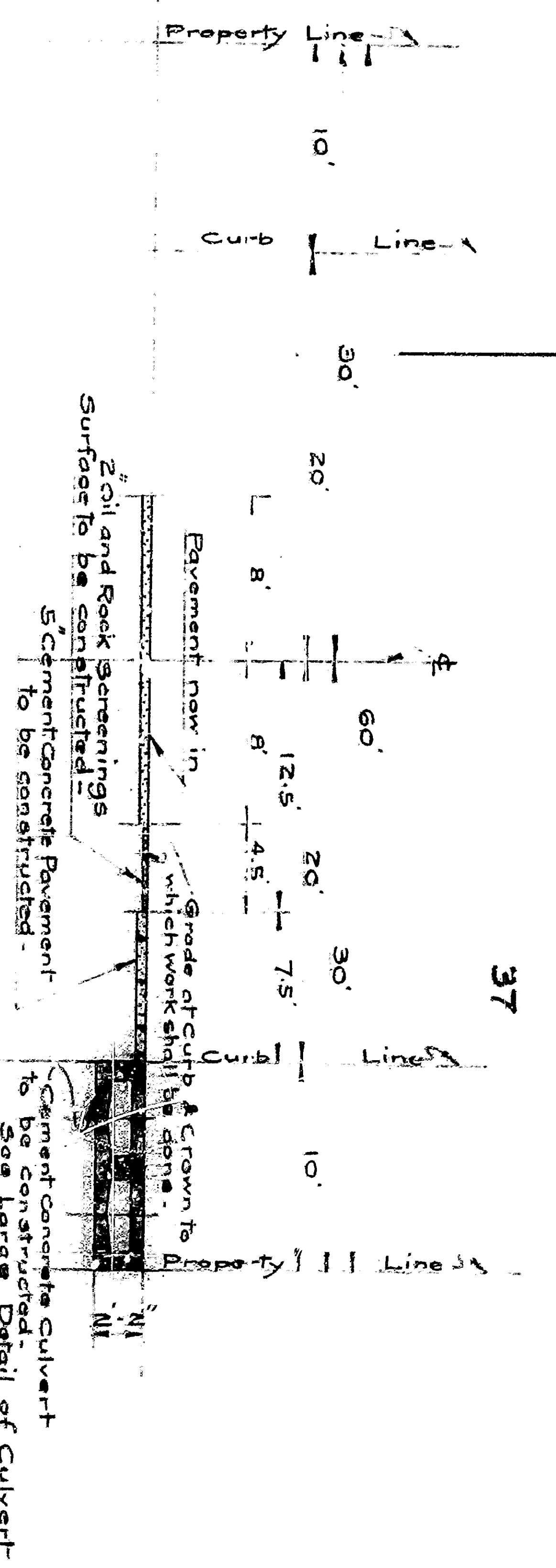

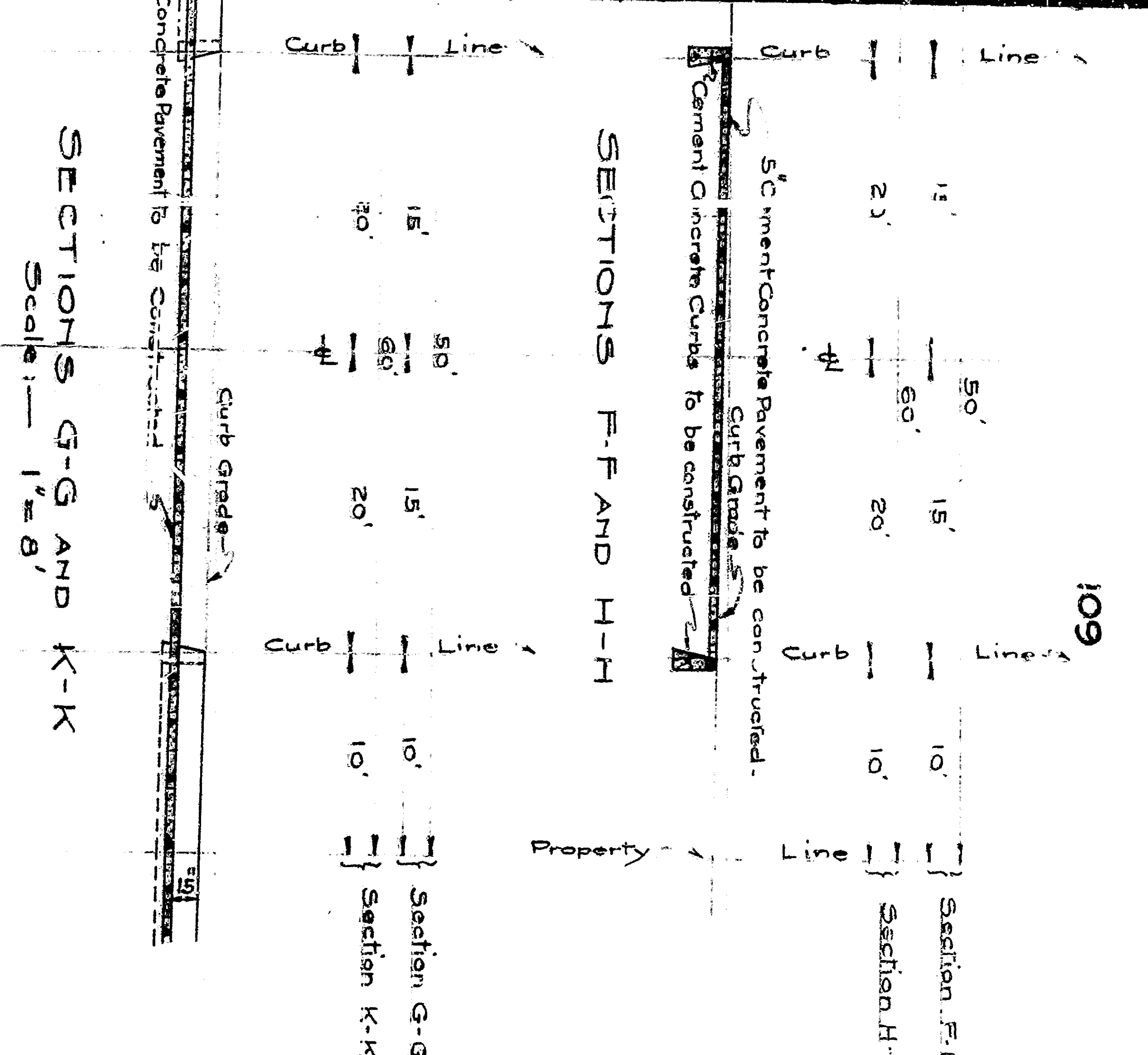

SECTIONS G-G AND K-K
Scale - 1" = 8'



SHEET NO. 2
PLAN NO. 1013
IN THE MATTER OF
ACQUISITION AND IMPROVEMENT DISTRICT NO. 3
OF THE CITY OF SAN BERNARDINO, CALIF.
PLANS AND PROFILES NO. 1013
AND
ASSESSMENT DISTRICT MAP NO. 1013
FOR THE IMPROVEMENT OF
STATE STREET
BETWEEN
CAJON STATE HIGHWAY AND BASE LINE STREET
IN THE
COUNTY OF SAN BERNARDINO, CALIF.

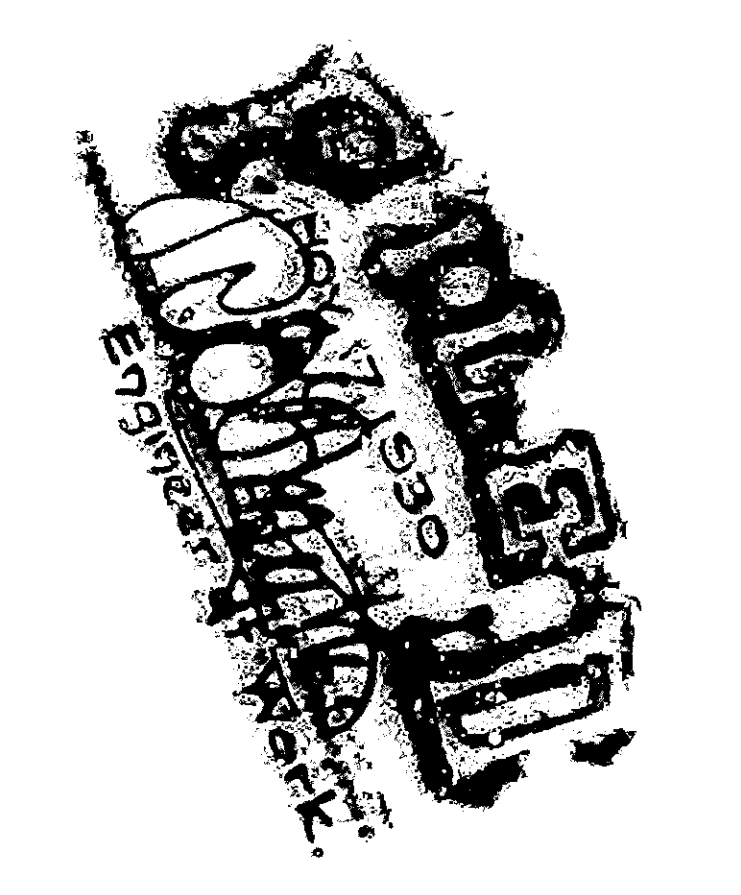

NOVEMBER 1929
 PLAN ADOPTED DECEMBER 1, 1930.
 NOTE: See Sheet No. 1 for legend.
R. D. ROSYTHE
 ENGINEER OF WORK

SECTIONS P-R AND L-L
SECTION P-R IS AS SHOWN
SECTION L-L IS REVERSED
 Scale - 1" = 8'

